



A3 Monochrome
Multifunction Printer

Apeos 3061 / 2561 / 2061

 **Apeos**[™]



Embark on your digital transformation journey

Designed to accelerate your digital transformation (DX) journey, new Apeos series with its smart and seamless integration features present itself as a trusted digital partner.



True scalable solutions to start your digital journey

Offering Scalability

Designing Simplicity

Creating Environmental Sensitivity



Apeos 3061 / 2561 / 2061

Apeos 3061	Apeos 2561	Apeos 2061
Monochrome 30 ppm *	Monochrome 25 ppm *	Monochrome 20 ppm *

* A4 LEF

Scan	Fax	Control Panel	Wireless LAN	SSD
Colour/Monochrome 80 ppm *	Super G3 FAX	7" Tilted Colour Touchscreen	Standard	Standard

* For Model-PFS-4T-B. Our Standard Document (A4 LEF), 200 dpi, to Folder.

Offering Scalability

Promote easier collaboration and enhanced accessibility with paperless office solutions.

Quick digitisation of high-volume originals

1 pass, 2-sided colour scanning of up to 80 ppm^{*1}

Although this model is a monochrome device, it comes standard with a high-speed 1-pass, 2-sided scanning Automatic Document Feeder that holds up to 130 sheets^{*2} and scans 2-sided document in one go, allowing you to digitise large documents swiftly and effortlessly.

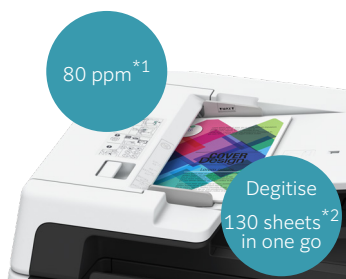

Note: Installed for Model-PFS-4T-B as standard.

*1: Our Standard Document (A4 LEF), 200 dpi, to Folder.

*2: 70 gsm paper. For Model-PFS-4T-B.

Copying and scanning ID Cards

You can copy both sides of an ID card on a single sheet of paper, or scan and transfer to SMB / FTP / SFTP / Email / URL / My Folder, allowing for easy access and printing when needed.

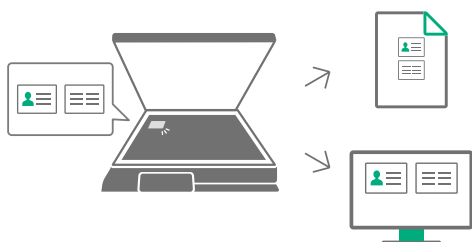

Simple sanning

With ScanAuto, the multifunction printer will automatically select scan settings such as document orientation, colour/black and white, 1-sided or 2-sided and sends the scanned files to your email address or PC after automatically removing blank pages.

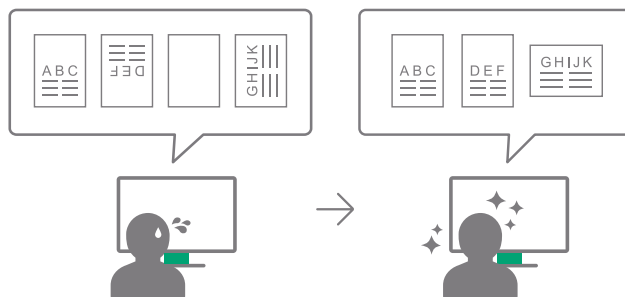

Conversion into Word/Excel®

Not only text but also tables and graphics can be recognized from scanned images, enabling direct conversion into editable data formats such as Microsoft® Word and Excel® documents.*

For example, it enables smooth reuse of paper-distributed documents and originals whose electronic files have been lost, further enhancing information utilization.

* Optional. Searchable PDF Kit 2.0 is required.

Make it easier to digitize and save each form

Scan small originals such as checks and invoices together

When custom-size^{*1} or small-sized documents are scanned, the Duplex Automatic Document Feeder automatically set into the nearest standard size.

Business cards, thick cheques, and thin paper receipts can also be easily digitised.

Business card management, which tends to be handled individually, can be managed, shared, and utilized on a PC by integrating with ApeosPlus Cards R^{*2}, a corporate business card management service.

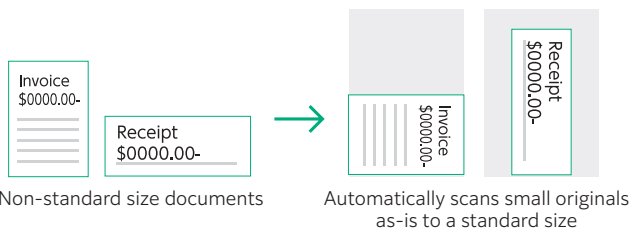

Note: Installed for Model-PFS-4T-B as standard.

*1: Custom Sizes from 49 x 85 mm to 55 x 91 mm are available from 38 to 209 gsm.

*2: ApeosPlus Cards R is a cloud service provided by FUJIFILM Business Innovation. A separate contract is required for this service. With the ApeosPlus Cards R Connector ADF Option, scanning is possible not only from the platen, but also from the Duplex Automatic Document Feeder B4-PC.

Scan Delivery Pro^{*}

Scan settings, storage destination designation and file renaming can all be completed with a single touch.

Additionally, it can split multiple documents using QR codes, and extract text within areas specified with a colour marker for automatically converting the extracted text into files names.

Scanned information can also be managed and utilised centrally, greatly improving the efficiency of scan jobs as well as the utilization of digitized information easier.

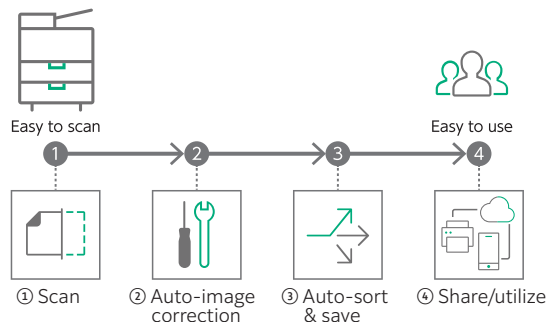

Using QR Codes or Barcode

When a QR code or barcode is attached to the header sheet or main text of the document, Scan Delivery reads and processes information from the QR code or barcode.

Note: Only for Apeos 3061 / 2561.

* Optional.



Streamline your fax operations

Save sent fax documents

Faxed documents can be automatically forwarded to the pre-specified PC or email address at the same time as sending, eliminating the need to manually file the documents.

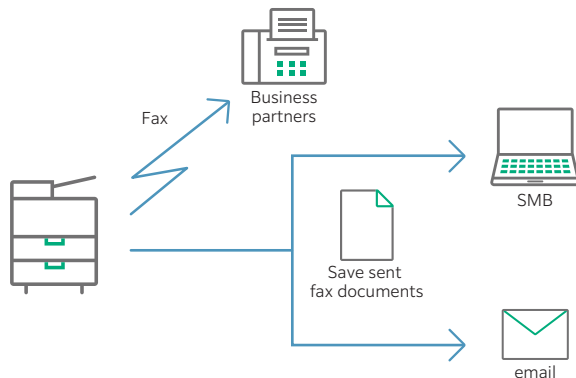

Paperless Fax Delivery*

Faxed documents can be automatically sorted and forwarded without printing. Manual sorting and organising of received documents are eliminated as they are automatically sorted into folders based on information such as fax number and received date.

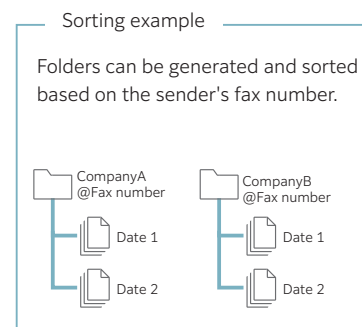

* Optional.

Seamless integration of multifunction printer and cloud storage

By linking FUJIFILM IWpro* on the multifunction printer with cloud storage, digitized documents become easier to use.

You can automate the entire process of assigning folder and file names to scanned or received fax documents, and storing them in a designated location, including the cloud storage.

Documents stored on cloud storage can be previewed directly from the operation panel of the multifunction printer before printing.

Seamless printing environment can be achieved without the need for a PC.

Print securely, anywhere, from any device

Documents uploaded to FUJIFILM IWpro can be securely output from remote office locations, enabling hybrid work styles for greater flexibility.

* FUJIFILM IWpro is a cloud service provided by FUJIFILM Business Innovation. A separate contract is required for this service.

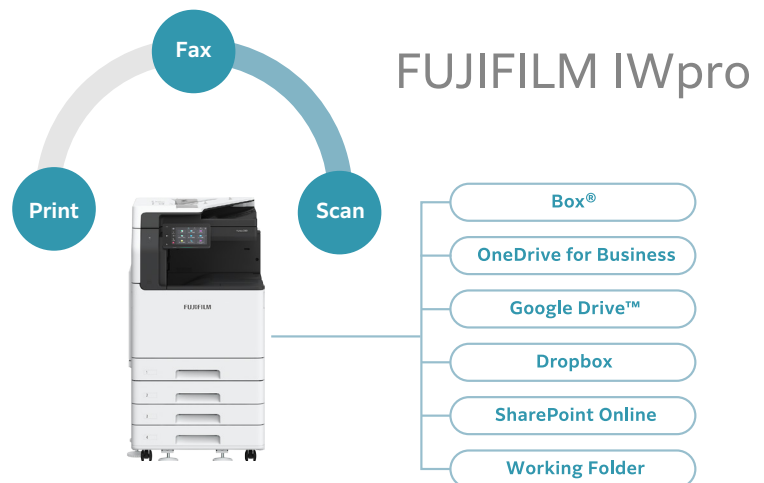

Safeguarding your DX journey with market-leading security

Protect from unauthorised user

- Unauthorised operations and access are prevented by user authentication and usage restrictions
 - Expansion with Secondary Ethernet* allows a single multifunction printer to be used on a separated network, etc.
- * Optional.

Protects Data

- Encryption of communication paths with TLS and IPsec
- Protection of scanned files and e-mails through encryption/electronic signatures
- Data writing to SSD is encrypted with robust AES-256 encryption, etc.

Protect from unauthorised access

- Account lock function
- Restriction of accessible IP addresses
- Prevention of software tampering during multifunction printer startup and operation
- Automatic repair function upon detection of tampering at startup, etc.

Prevent information leaks due to operational errors

- Fixing the delivery destination of scanned documents
- Double input of fax destinations, etc.

Designing Simplicity

Designed for all, our devices deliver ease of use, accessibility and personalisation features for a true intuitive experience.



Easy to use, with remote operation

7-inch control panel

The control panel serves as the gateway, connecting you to various smart applications on the multifunction printer at the touch of your finger. The touch panel provides excellent visibility and operability, responding to every touch and swipe for effortless navigation.

Login name display

NFC touch area

Easily connect with mobile devices. Using Print Utility^{*1}, you can perform basic multifunction printer operations^{*2} from your smartphone.



Note: Connect to machine via wireless environment or Wi-Fi Direct[®] connection.

Note: AirPrint[®], Mopria[®] Print Service, and Mopria Scan are supported for printing or scanning by using a mobile device.

*1: It can be downloaded free of charge from Google Play[™] or App Store.

*2: Copy, Fax, Print, Scan.

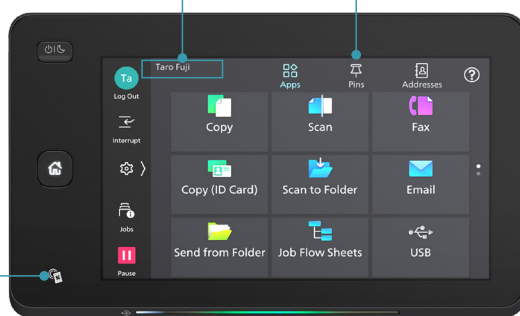

Note: The displayed screen differs from the factory default. Additionally, the LED lighting status varies depending on the situation. The LED lighting status in the image is for illustrative purposes only.

Quickly access frequently used settings

On the Pins screen, you can restart jobs from the job history. Frequently used settings can be "pinned" to save time.

Remote Operation Panel



Set up and update remote multifunction printers

Device administrators can set up and manage the multifunction printer remotely. By launching the Remote Operation Panel from a web browser, the multifunction printer's control panel can be displayed to and operated from a PC.

Note: Within the same intranet. While the Remote Operation Panel is active, the multifunction printer's control panel cannot be operated. Additionally, the Remote Operation Panel cannot be launched while the user is operating the multifunction printer.

Fits in limited spaces, offering greater flexibility in office layout

Small footprint fits in every office space

The compact design with width of 577 mm and depth of 650 mm^{*} fits everywhere, including tight spaces, maximising office space utilisation.

* For Model-P-1T.

Wireless LAN supported as standard

It offers greater flexibility, as you can install the machine even without a wired network connection.



Comfortable operation while seated, ideal for counter service

Note: Standard (Model-PF-1T)^{*}
+ 1 Tray Module^{*} + Caster.



Store backup paper sheet and toner cartridges in the cabinet

Note: Standard (Model-PF-1T)^{*}
+ 1 Tray Module with Cabinet^{*}.

* Optional.

Professional print quality tailored to your business needs

Easily achieve high-quality printing by loading envelopes and postcards in the standard tray

Supports paper weights from lightweight 52 gsm to heavyweight 300 gsm in the standard tray.

With the capability to print on envelopes^{*1} and postcards, in-house creation of direct mail is possible, allowing versatile use for a wide range of business application such as shop cards and even long banner printing^{*2}

*1: Paper weight from 106 to 300 gsm, when the Envelope Feeder is on.

*2: Long sheets up to 297 x 1,200 mm.

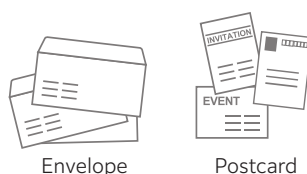

Creating Environmental Sensitivity

Driving organisation awareness towards creating a low impact environment with advanced features such as low melting point (low energy) toner technology, smart power-saving feature or staple-free finishing.



The multifunction printers of the future

Our products are developed with unique innovations and technologies that balances environmental impact reduction and usability.

New toner and a fusing unit with low fusing temperature and high image quality

Toner fusing is the most energy-intensive process in a multifunction printer. To reduce power consumption, we are introducing new technologies in our toner and fusing unit. Our new toner features functional resin and small particle technology, enabling fusing at an industry-leading low temperature^{*1}. Together with the new fusing unit, the Apeos 3061 series achieves a fusing temperature that is 22 degrees lower than the previous model^{*2}.

This breakthrough reduces environmental impact while maintaining exceptional image quality, delivering sharp text, precise lines and smooth gradation.

^{*1}: The toner fusing temperature for A3 multifunction printers based on internal study conducted in May 2025.

^{*2}: Apeos 3060 series.

Energy saving

Equipped with "Smart Energy Management Technology" that enables partial power control, distributing the power only to the features requested when waking from sleep mode without powering the entire multifunction printer, making it possible to reduce power consumption.

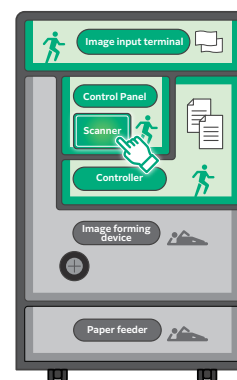

Image Provided by Green Park FLOOP

	Apeos 3061	Apeos 2561	Apeos 2061
TEC Value*	0.31 kWh	0.26 kWh	0.21 kWh

*Figures according to the measurement method established by the International Energy Star Program.

FUJIFILM Business Innovation aims to address environmental issues through resource circulation efforts in our business activities.

Designed for now and for the future

In the effort to promote recycling of resources, recycled plastic materials are used^{*} for parts such as the front cover and trays. We have overcome challenges to devise ways to suppress uneven colour of the appearance of recycled plastic, which is said to be difficult to mold. And by improving the strength and rigidity of the parts, we ensure the quality of the product.

Furthermore, our products have been redesigned to allow easy disassembly and cleaning, making them easy to reuse and recycle in the future.

^{*} In the case of 4 Tray configuration with Duplex Automatic Document Feeder. 15 % of the total plastic weight of the device is recycled material.



For information on reducing environmental impact through our products, please access via the QR code



Reliable support system

Easy solutions to resolve problems

From supplies replacement to unexpected device failures, most problems can be resolved without waiting for the service representatives or sales representatives.

1. Resolve problem using the "Help" function on the device

- Self Help information is available on the control panel
- Self Help information can be accessed via the mobile device by scanning the QR code displayed on the control panel

2. "Remote Assistance" with the help of operators

- Connects directly to the Support Centre
- An operator will remotely access the multifunction device to resolve the problem by guiding through the steps on the shared control panel

Keeping a close eye on your multifunction device on a daily basis

Connecting your multifunction printer to our EP service^{*} via the internet allows for checking of billing meter, automatic delivery of consumables when cartridges level is low, daily status monitoring, and machine error detection for early intervention to rectify problem. This minimises operation downtime and reduces administrator's burden.

Note: The content of the services provided may vary depending on the usage region. For details, please contact one of our sales representative.

^{*} You need to apply for using the EP service. (free of charge)

Device Setup Editor

Device Setup Editor is a service that always backs up the latest setting information to a cloud server. It allows you to be prepared for unexpected situations and use your multifunction printer with confidence.

Note: You need to apply for using the Device Setup Editor. (free of charge)

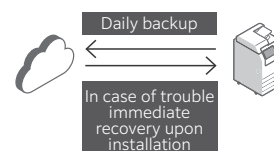

Versatile Options for Post-processing

3 Way output with a new compact finisher

Finisher A3 that can be installed in the main unit.

Combined with the side tray*, paper can be output to up to 3 locations.

In addition to notifying users with a light when paper is output, the finisher features a quiet design for reducing operating noise.

* Optional.

Staple-free Staple*¹

In addition to Single stapling up to 10 sheets*², Dual stapling is also supported.

*1: For Finisher-B5.

*2: 80 gsm or less.

3 Way output with Exit 2* Tray and Side Tray*

Supports output from three locations for Copy, Fax, and Print functions. This way, important received faxes are not missed, and output paper can be quickly retrieved.

* Optional.



Note: Exit 2 Tray cannot be installed with various finishers.

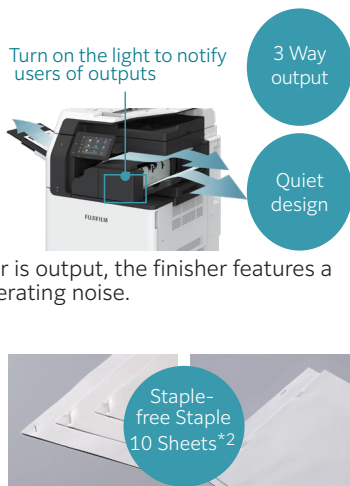

		Finisher-A3	FinisherB4/B5 + Booklet maker Unit	
			B4	B5
Stapling capacity		Staple	50 sheets* ¹	
		Staple-free Staple	—	10 sheets* ²
Punch		Hole punching for binders	—	2/4 hole* ³
Saddle Staple/Single Fold		For making catalogs and booklets	—	O* ⁴

*1: A4 size. Finisher-A3 is up to 30 sheets for B4 or larger.

*2: 80 gsm or less.

*3: 2/4 Hole Punch Unit is required.

*4: Booklet Maker Unit is required. Saddle Staple and Single Fold on Finisher-B4/B5 make creases without folding.

Flexible Combination According to Your Installation Site or Purpose

●: Standard, O: Optional

		Copy	Print	Fax	Scan	Duplex Automatic Document Feeder		Standard tray
						1 pass, 2-sided	Duplex	
Apeos 3061 / Apeos 2561	Model-PFS-4T-B	●	●	●	●	●	—	4-tray
	Model-PFS-4T	●	●	●	●	—	●	4-tray
	Model-PF-4T	●	●	●	O	—	●	4-tray
	Model-P-1T	●	●	O	O	—	O	1-tray
Apeos 2061	Model-PF-1T	●	●	●	O	—	●	1-tray
	Model-P-1T	●	●	O	O	—	O	1-tray

Recommended configuration



*Only for Apeos 2061.

FUJIFILM

FUJIFILM Business Innovation Corp.

9-7-3, Akasaka Minato-ku, Tokyo
107-0052

fujifilm.com/fb

FUJIFILM Business Innovation aims to address environmental issues through climate change mitigation and resource circulation efforts. The product specifications, appearance and other details in this brochure are subject to change without notice for improvements.

Reproduction Prohibitions Please note that reproduction of the following is prohibited by law : •Domestic and foreign currencies, government-issued securities, and national bonds and local bond certificates. •Unused postage stamps, post cards, etc. •Certificate stamps stipulated by law. •Reproducing works forming the subject matter of copyright (literary works, musical works, paintings, engravings, maps, cinematographic works, drawings, photographic works, etc.) is not permitted unless the reproduction is for the purpose of personal use, family use or other similar uses within a limited circle.

Trademarks •FUJIFILM and FUJIFILM logo are registered trademarks or trademarks of FUJIFILM Corporation.

•Apeos, DocuWorks, Working Folder, and Cloud Service Hub are registered trademarks or trademarks of FUJIFILM Business Innovation Corp.

•Microsoft, Active Directory, Azure, Microsoft Entra, Microsoft Edge, Excel, OneDrive, PowerPoint, SharePoint, Microsoft Teams, Windows, and Windows Server are registered trademarks of US Microsoft Corporation in the U.S. and other countries. •Apple, Mac, macOS, OS X, AirPrint, and AirPrint logo are trademarks of Apple Inc. registered in the U.S. and other countries and regions. •Adobe, Adobe logo, PostScript, and PostScript logo are either registered trademarks or trademarks of Adobe in the United States and/or other countries. •Mopria, the Mopria Logo, and the Mopria Alliance word mark and logo are registered and/or unregistered trademarks and service marks of Mopria Alliance, Inc. in the United States and other countries. •QR Code is a registered trademark of DENSO WAVE INCORPORATED. •All product names and company names mentioned in this brochure are trademarks or registered trademarks of their respective companies.



For Your Safety

Before using the product, read the Instruction Manual carefully for proper use. Use the product with the power source and voltage specified. Be sure to establish ground connection. Otherwise, electronic shock may result in the case of a failure or short circuit.